

KIT AUTO

INSTALLATION, USE AND MAINTENANCE MANUAL

EN

Dear Customer, congratulations on choosing this Made in Italy ATLAS FILTRI product.

Please carefully read and keep this document that will help you best enjoy and use all our products. Continue to prefer us and beware of imitations. KIT AUTO is suitable to the HYDRA self cleaning filters series and to the filters series with discharge system PLUS S 3P BX and CX, DP S and DP S DS, K PLUS S 3P and K DP S.

- The "AUTO KIT" cyclical timer cyclically operates the solenoid valve at each interval set and for the set time.
- The interval and time are programmable:

Interval: 1-255 hours

Time: 1 to 255 seconds

SOLENOID VALVE CONNECTIONS

- Screw in the nipple with O-ring on the bottom of the cup.
- Screw in the solenoid valve, being careful that the flow direction arrow faces down.
- Screw the drain funnel or hose fitting onto the solenoid valve.
- Connect the programmer connector to the specific solenoid valve housing.

BUTTONS

SET button: used to program the system.

MANUAL button: operates the washing solenoid valve.

PROGRAMMING

Connect the power supply by keeping the SET button pressed:

- 1 The display shows the words "SETTING DURATION" (to set the washing time)

Release the SET button and follow the instructions on the display:

- 2 The display shows the words "INCREASE PRESS ST" - to increase the washing time (in seconds), press and hold down SET until the desired interval is reached (the display will show the values increased in seconds, with the display flashing).

- 3 Then the display shows the words "DECREASE PRESS ST" - to decrease the washing time (in seconds), press and hold down SET until the desired interval is reached (the display will show the values decreased in seconds, with the display flashing).

At this point, sequences 1-2-3 will be repeated again to be able to correct any errors.

- 4 The display shows "SETTING LAPSE" (to set the interval between two subsequent washes)

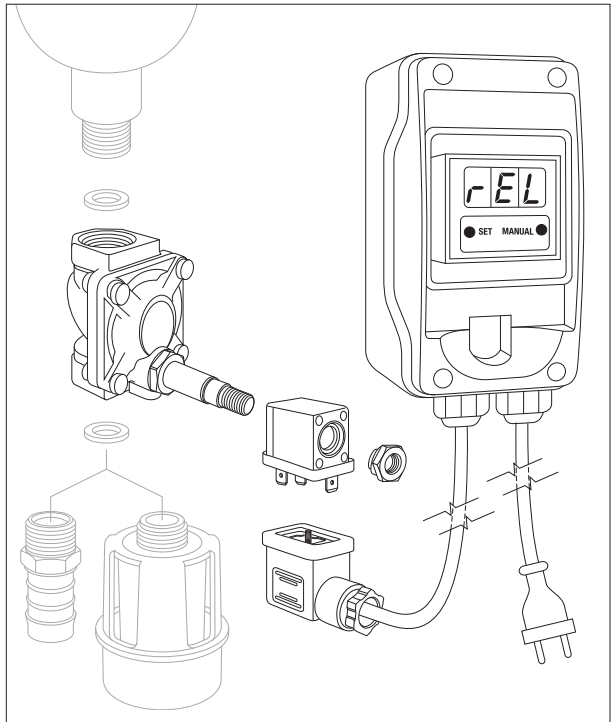

Manufacturer's identification: ATLAS FILTRI s.r.l.

Headquarter: via Pierobon, 32 | Production site: via del Santo, 227
I-35010 Limena, Italy - Tel. +39.049.76.90.55 Fax +39.049.76.99.94
www.atlasfiltri.com



COMPANY WITH
MANAGEMENT SYSTEM
CERTIFIED BY DNV GL
= ISO 9001 =
= ISO 14001 =
= ISO 45001 =

5 The display shows the words "INCREASE PRESS ST" - to increase the interval (in hours), press and hold down SET until the desired interval is reached (the display will show the values increased in hours, with the display flashing).

6 Then the display shows the words "DECREASE PRESS ST" - to decrease the interval (in hours), press and hold down SET until the desired interval is reached (the display will show the values decreased in hours, with the display flashing).

At this point, sequences 4-5-6 will be repeated again to be able to correct any errors.

The programming ends with the display showing the words "STORAGE DATA".

The set values will be shown at this point:

X - H.lapse = (Hours Time Lapse) the interval in hours between one wash and the next.

Duration - X Sec. = washing time in seconds.

Once the programming has been completed, the display will show:

X H.La - (Hours Lapse) the interval in hours between one wash and the next.

X H.Re - (Hours Remaining) number of hours remaining before the next wash.

SWITCH-ON

The following are shown on the display when it switches on: first the interval in hours "Hinterv." H Tm Lapse (Hours Time Lapse) then the operating time in seconds "Duration" actually programmed.

The system then carries out a washing cycle with a set time.

After the washing cycle has been completed, the timer turns on and shows the following on the display:

X H.In - H.La (Hours Lapse) the interval in hours between one wash and the next.

X H.RS - H.Re (Hours Remaining) number of hours remaining before the next wash.

NOTE: if there is a power failure during the washing stage, the system will resume from the switch-on cycle.

WASHING CYCLE

When the washing cycle starts, the solenoid valve is activated with the relative "Enable ElectrValv" message. Then during the cycle the display shows the following:

- the programmed time in seconds
- the seconds remaining before deactivation.

At the end of the washing cycle, the solenoid valve is closed with the relative "Disable ElectrValv" message and the display shows the following:

X H.In - H.La (Hours Lapse) the interval in hours between one wash and the next.

X H.RS - H.re (Hours Remaining) number of hours remaining before the next wash.

WARNINGS

The pin type adapter must be inserted in a standard socket, equipped with ground contact and protected by a circuit breaker.

Make sure the adapter is firmly inserted in the socket and located in a protected area, away from accidental contacts, water sprays, humidity and heat sources.

WARNING: the programmer must be set with dry hands and appropriate tools.

HYDRAULIC CHECKS AND START-UP

Proceed as follows after filter drain installation and connection:

- Make sure there are no water leaks by gradually opening water supply to the filter;
- Make sure the system is correctly positioned to facilitate routine maintenance operations;
- Make sure sampling faucets are installed before and after the device;
- Make sure the drain pipe is firmly secured and that no water leaks during filter cleaning;
- Check whether any flood protection devices are needed, installed and efficient;
- Check whether an adequately dimensioned drain is installed and periodically check for clogs;
- Check system correspondence with any local standards or recommendations;
- Gradually fill the filter 3/4 full and release air in the filter.

PROBLEM	CAUSE	SOLUTIONS
Water leaks between the cup and solenoid valve	- nipple o-ring worn.	- replace the o-ring.
Water leaks at drain	- build-up in the solenoid valve body.	- manual clean once or several times.
After the connecting to power supply the display does not turn on.	- the plug is not fully inserted; - the programming panel is broken.	- check if correctly inserted; - contact the dealer.



DECLARATION OF COMPLIANCE

Manufacturer's address: ATLAS FILTRI srl - Via del Santo 227, 35010 Limena (PD) - ITALY

HYDRA AUTO filters are constructed in accordance with the following European directives:

N° 2004/108/EC - Electromagnetic compatibility.

N° 2006/95/EC - Low voltage directive.

UNI EN 1717 - Protection against pollution of potable water in water installations and general requirements of devices to prevent pollution by backflow.

Specifically, the following harmonised regulations were applied:

EN 50081-1, EN 55014, EN 60800-2, EN 61000-4-4, EN 61000-3-2, EN 61000-3-3, EN 55104, EN 60204-1.